

How to pin CheckInSchools to your home screen?

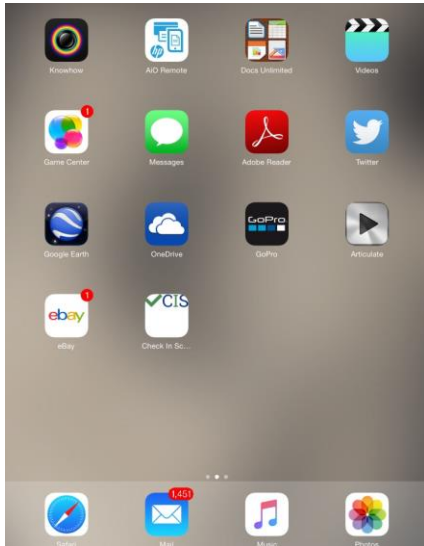

You can pin CheckInSchools to your home screen and it will appear just like any other app. This allows quick launching with a single tap. For ease of use we recommend that you ask all pupils to pin Checkinschools to the home screen of their smart devices.

Android

1. Start by opening CheckInSchools in your browser.

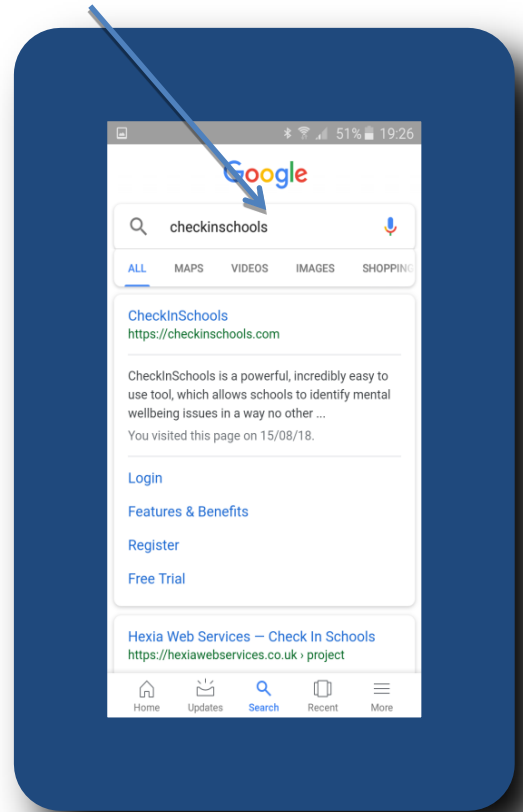

2. Hit the menu button. (The three vertical dots.)

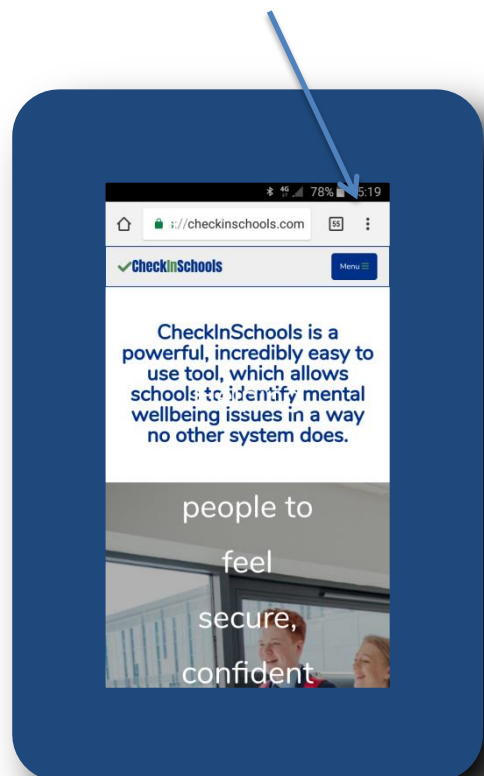

3. Select *Add to Home screen*.

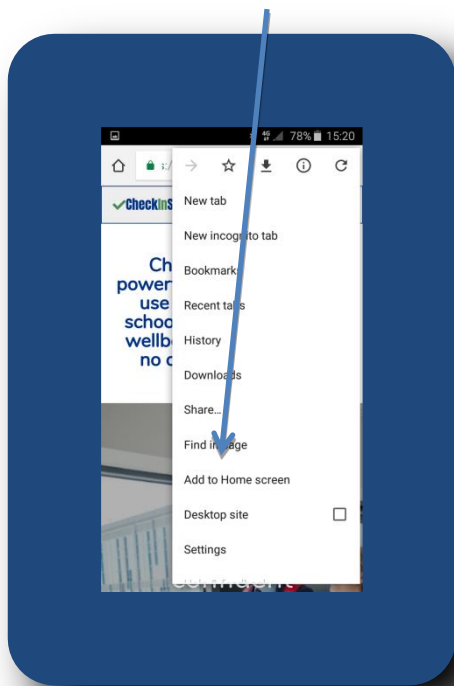

4. Select a name for the new icon e.g. *CheckInSchools*.

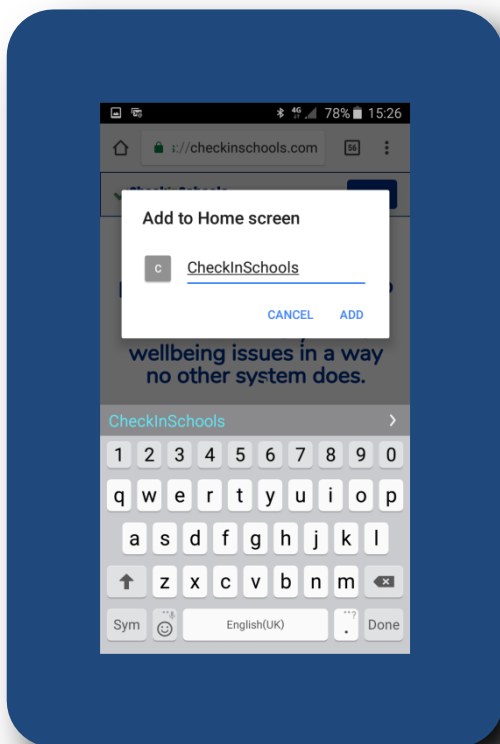

5. Click *ADD*.

IOS

1. Launch the *Safari* app.



2. Connect to CheckInSchools.

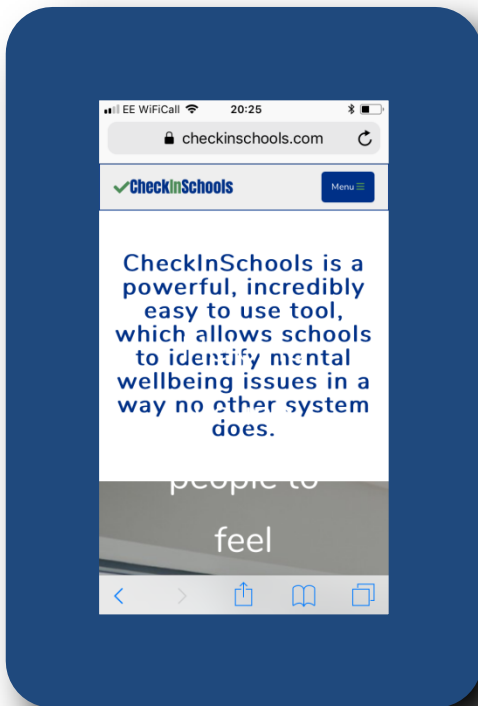

3. Tap on the *share* button.

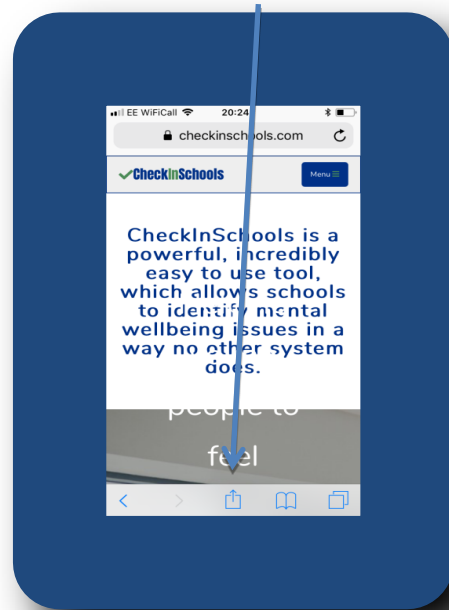

4. Tap on *Add To Home Screen*.

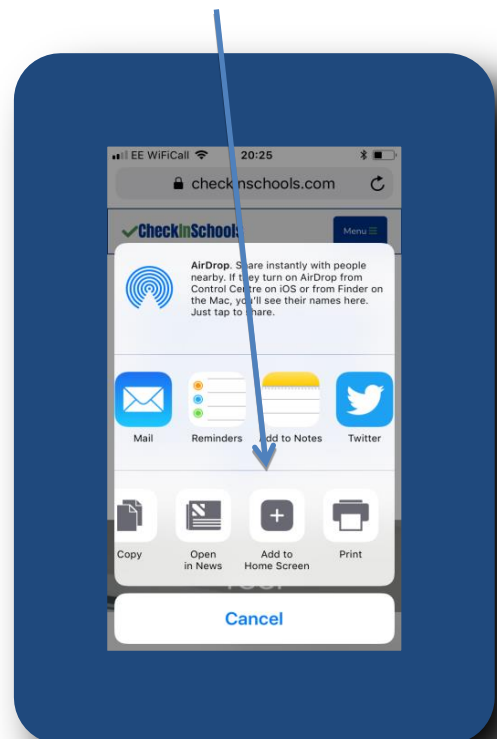

5. Select a name for the new icon
e.g. CheckInSchools and click
Add.

